



Osaka Luxury Tower Apartment ORC Prio Tower

Mash Co., Ltd.
3-11, Fujishirodai 2 chome, Suita City, Osaka Prefecture
Osaka Prefecture Governor License (2) No. 58189
Main Line (Japanese): 06-6450-6188
English and Chinese Service Hotline: 090-9879-4615

Property Information

Address: 1-2-30 Benten, Minato-ku, Osaka City, Osaka

Prefecture Date of completion: March 1993

Structure: Reinforced concrete structure

Total number of households: 353 Units

Total floors: 48 floors/2 underground floors, 50 above ground floors

Exclusive area: 196.37m²

Construction: Shimizu Corporation, Haseko Corporation, Konoike Group

Management company: Haseko Community

Management form: Full entrustment

Land rights: Freehold

Transportation:

JR Osaka Loop Line "Bentencho" Station, about 4 minutes walk

Osaka Metro Chuo Line "Bentencho" Station, about 4 minutes walk



Room Plan

Price: 165,000,000yen

Unit type: 3LDK

Main orientation: Southeast/Northeast

Management fee: 45,170 yen/month

Renovation fund: 58,910 yen/month

Parking lot: Yes (Management fee 3,500 yen/month)

Current situation: Vacant/ Delivery time: Please inquire

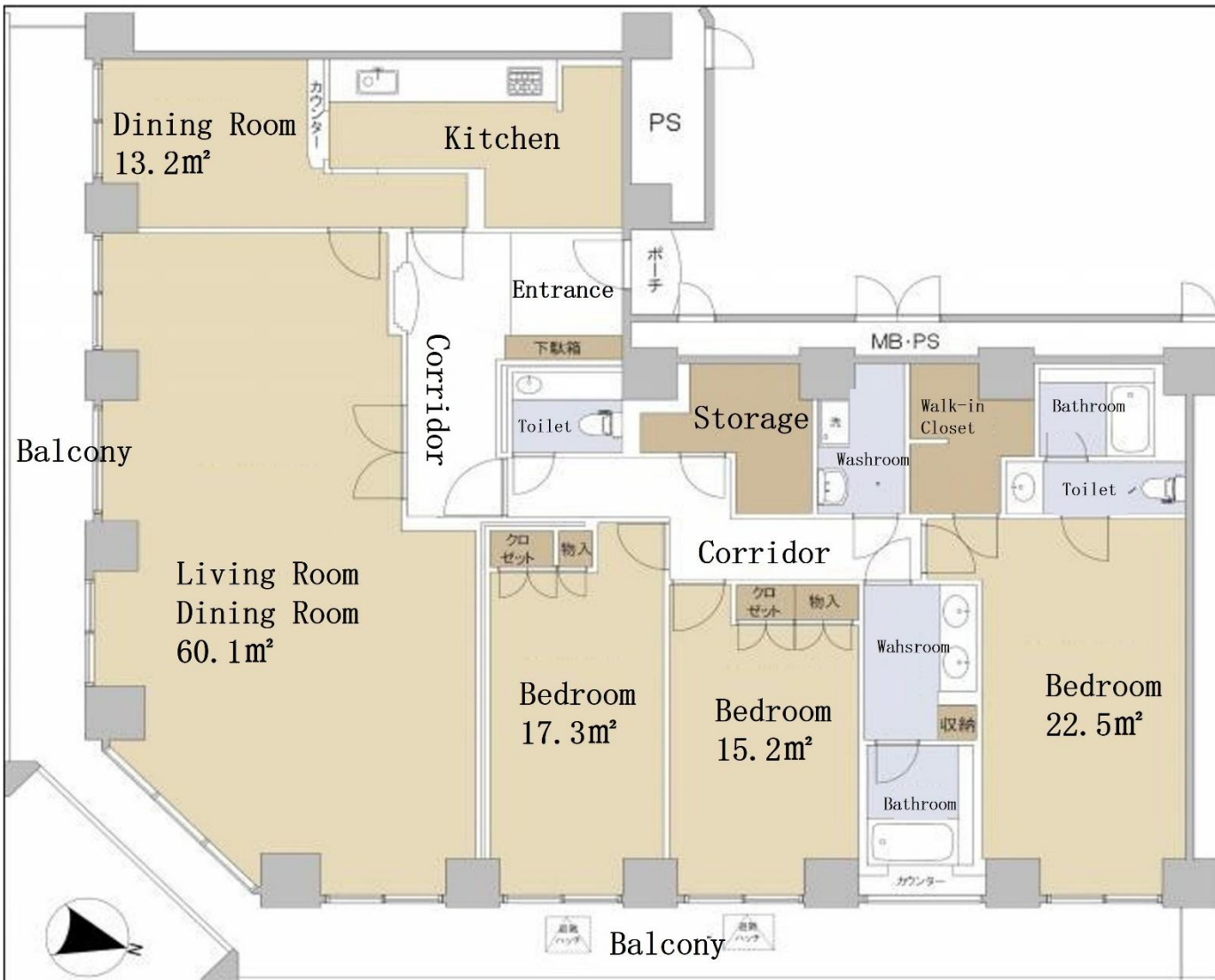

Remarks:

Pets are allowed (subject to regulations)

Southeast/northeast corner unit, good lighting and view

All rooms are connected to balconies, each over 15 square meters

The master bedroom is equipped with a dedicated vanity, toilet, and bathroom

Surrounding environment:

"KONAN Bentencho Store" 1 minute walk

"LOPIA Osaka Bay Tower Store" 1 minute walk

"KIRINDO Bentencho Store (drug store)" 1 minute walk

"DAISO Osaka Bay Tower Store (100-yen store)" 1 minute walk

"Soraniwa Onsen" 1 minute walk

"LIFE Bentencho Store (supermarket)" 4 minutes walk

"MEGA Don Quijote Bentencho Store" 10 minutes walk

"Isoji Park" 7 minutes walk