



Senri New Town Satakedai area



Land area 515m²
(approx. 156 tsubo)
Existing old house 384m²

Suita City Satakedai 5-chome Land for sale

Land Price **158,000,000** yen

Land overview: ◎5-7-1 Satakedai, Suita City
◎Freehold ◎Land type: residential land
◎Type 1 low-rise residential area ◎Land area: 514.51m²
◎Old house attached ◎Date of construction: Built in 1962, extended in January 1969 ◎Wood and reinforced concrete construction, tile and slate roofing, 2 stories with 1 basement floor ◎Building area: 384.39 m2 ◎Width: 6.2 m (west side), sidewalk: 3.1 m (south side) ◎Proximity: 20.1 m (west side), 24.5 m (south side sidewalk) No private road charge ◎No setback
◎Building coverage ratio: 40% Floor area ratio: 80%
◎Delivery: Immediately after payment

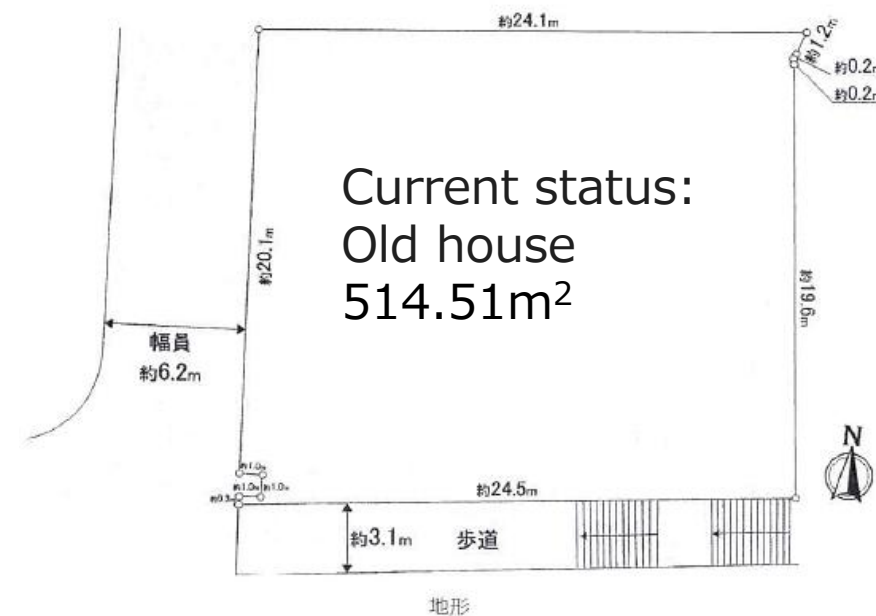

Mash Co., Ltd.
3-11, Fujishirodai 2 chome, Suita City, Osaka Prefecture
Osaka Prefecture Governor License (2) No. 58189
Main Line (Japanese): 06-6450-6188
English and Chinese Service Hotline : 090-9879-4615

Transaction type: Dedicated
Commission: Negotiable
Advertising: Not allowed
English Agents: Yujiao Wu