



**Luxury Villa in Higashinada Ward,
Kobe City, Hyogo Prefecture**

PROUD SEASON Mikage

Sumiyoshi Mountain Stage 1

Mash Co., Ltd.
3-11, Fujishirodai 2-chome, Suita City, Osaka Prefecture
Osaka Prefecture Governor License (2) No. 58189
Main Line (Japanese): 06-6369-7347
English and Chinese Service Hotline : 090-9879-4615

Property Information



Address:
Sumiyoshiyamate 2-chome,
Higashinada-ku, Kobe City, Hyogo Prefecture

Completion Date: March 2020

Building Structure: Wooden construction

Total Floors: 2 above ground

Land Area: 123.40m²

Building Area: 115.47m²

Land Ownership: Freehold



Access:

- 5-minute walk from Mikage Station on the Hankyu Kobe Line
- 15-minute walk from Sumiyoshi Station on the JR Kobe Line

Room Plan

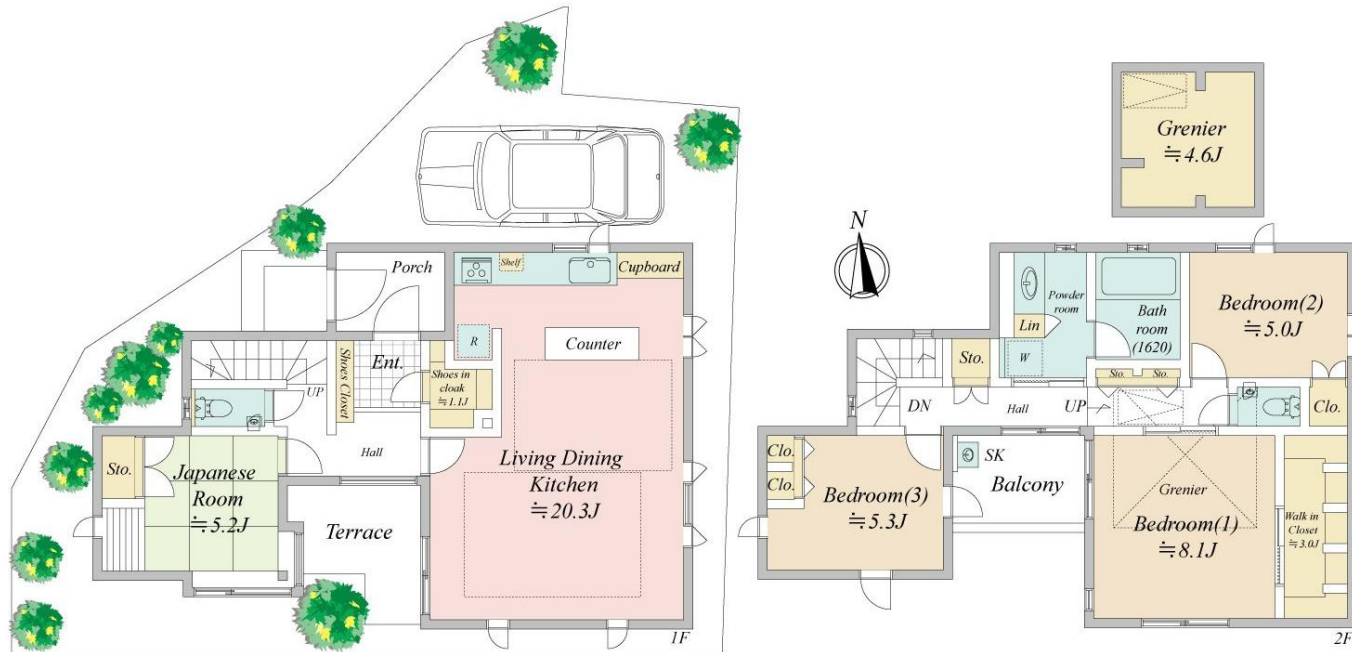

Price: **118,800,000 yen**

Layout: 4LDK + Attic Storage + WIC + SIC

Main Orientation: South

Parking: Space for 1 car

Current Status: Occupied

Closing: Negotiable

Remarks:

Custom bookshelves in Bedrooms 1 & 2,
TOM SAUYER stained glass,
EcoCarat Plus wall in the living room
(humidity control and odor absorption),
Evergreen trees on the terrace,
Custom curtains throughout,
LDK over 33 sqm, raised ceiling (approx. 2.7m),
Electric vehicle charging equipments.

Room Photos

