



With Over 700 Square Meters of Land

Luxurious Japanese-Style Villa

in Kaizuka City,

Osaka Prefecture

Mash Co., Ltd.
3-11, Fujishirodai 2-chome, Suita City, Osaka Prefecture
Osaka Prefecture Governor License (2) No. 58189
Main Line (Japanese): 06-6369-7347
English and Chinese Service Hotline : 090-9879-4615

Property Information

Address:

207 Tsutsumi, Kaizuka City, Osaka Prefecture

Completion Date: September 1992

Building Structure: Wooden Structure

Total Floors: 2 above ground, 1 underground

Land Area: 795.65m²

Building Area: 487.95m²

Land Rights: Freehold

Access:

- 6-minute walk to JR Hanwa Line "Izumi Hashimoto" Station
- 14-minute walk to Mizuma Railway Kinki "Sato" Station



Room Plan

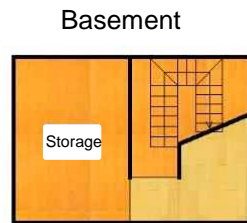
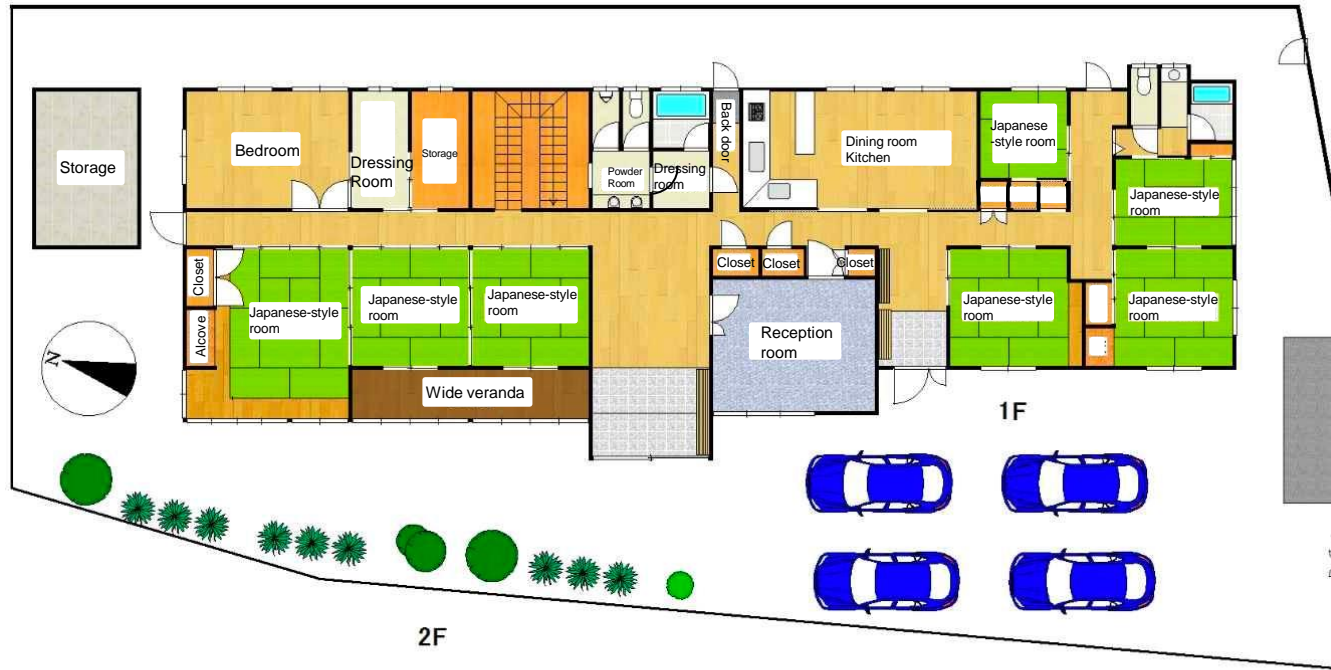

Price: 120 million yen

Layout: 12SLDK (12 rooms with a living, dining, and kitchen area, plus an extra storage room)

Main orientation: South

Parking: Garage available

Current status: Rented

Closing: Negotiable

Room Photos

