



TOKYO TWIN PARKS LEFT WING

Mash Co., Ltd.
3-11, Fujishirodai 2-chome, Suita City, Osaka Prefecture
Osaka Prefecture Governor License (2) No. 58189
Tel: 06-6369-7347

Property Information



Address:

1-chome, Higashi-Shinbashi, Minato-ku, Tokyo

Completion Date: September 2002

Structure: Reinforced Concrete

Total Floors: 47 above ground, 2 below ground

Total Units: 1,000 units

Management Company:

Mitsui Fudosan Residential Service Co., Ltd.

Premium Management Services: :

- Fully Entrusted Management
- 24-hour Onsite Concierge

Construction: Taisei Corporation

Luxurious Communal Amenities:

- Panoramic Observation Lounge
- Elegant Party Room
- Exquisite Guest Rooms
- State-of-the-Art Fitness Center
- Well-Stocked Library
- Modern Wine Cellar
- Fully Equipped Conference Center
- Soundproof Piano Room
- Convenient Bicycle Rental Service
- Comprehensive Front Desk Services including Dry Cleaning and Parcel Delivery/Collection

Room Plan

Comprehensive Renovation Completed on: June 21, 2024

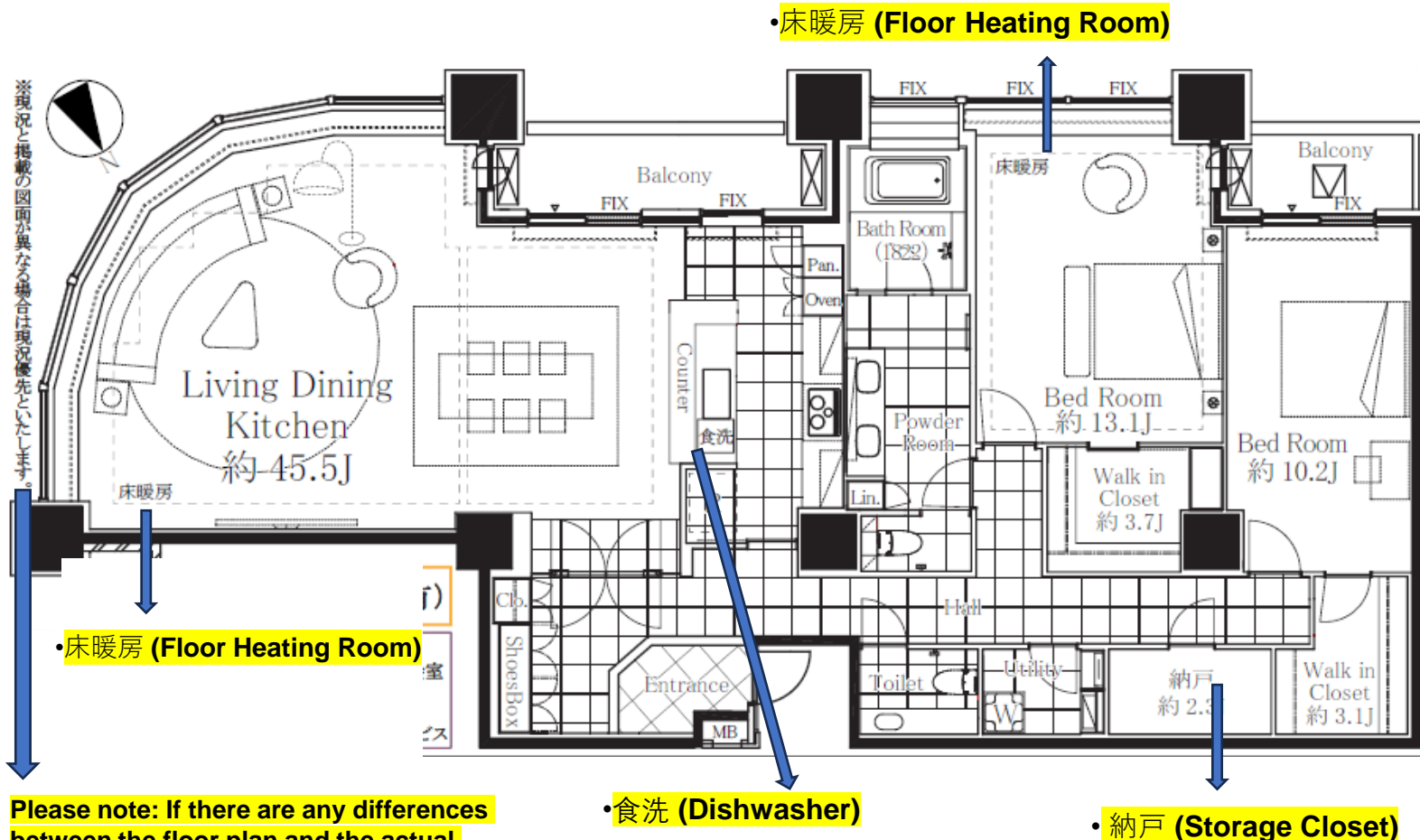

Sales Price: ¥898,000,000

Exclusive Area: 173.21 m²

Floor Plan: 2LDK

Repair Fund: ¥60,790/month

Management Fee: ¥64,100/month

Underfloor Heating Basic Fee: ¥4,700/month

Internet Connection Fee: ¥1,595/month

Top Floor Common Area Usage Fee: ¥6,600/month

Main Orientation: Southeast · Southwest

Parking Fee: ¥70,000/month

Current Status: Vacant

Move-in Date: Negotiable

Remarks: Pets welcome (subject to guidelines)

Elegant Renovations:

- Fully Renovated Kitchen
- Luxuriously Renovated Full Bathroom
- New Double Basin Washstand with Triple Mirrors
- Newly Installed Premium Toilet
- Advanced Underfloor Heating System

Please note: If there are any differences between the floor plan and the actual property condition, the actual property condition will be considered accurate.



Tokyo Tower
(東京タワー)

Views from the bedrooms



Hama-rikyu Gardens
(浜離宮恩賜庭園)

Odaiba (お台場) Rainbow Bridge (レインボーブリッジ)

Views from the Living Room